

4 1/2" A421 & 5 1/4" A423 SUPER CENTURION "250" W/ TWO HOSE NOZZLES
W/ TWO HOSE NOZZLES & ONE PUMPER NOZZLE W/ HIGH SECURITY SHOE
- 250 P.S.I. W.P. - 500 P.S.I. TEST, 1997 STYLE.

DWG. FH. 168

| REV. | DESCRIPTION | REF. | DRWTR | CHKR | APP | DATE |
|------|--|------|-------|------|-----|---------|
| E | REVISE ITEMS #1, 4, 14, 18, 36, 38, 39, & 65 | | JMG | | | 11-7-13 |
| D | REVISE ITEMS #11 & 31 | | MRG | | | 3-13-12 |
| C | REVISE ITEMS #11 & 31 | | ANC | | | 12-1-09 |
| B | ADDED ITEMS 67 & 68 | | ANC | | | 1-25-08 |
| A | REVISED FLAPPER ASSM. TO INCLUDE BRASS SEAT | | ANC | | | |

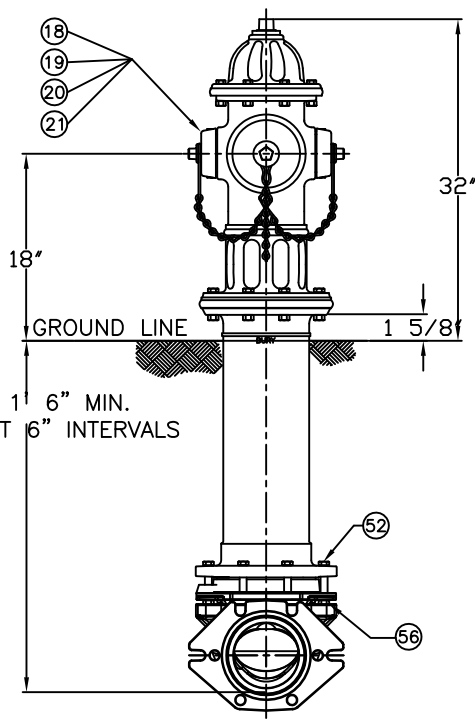

| PARTS LIST | | | | |
|------------|--------------------------|-------|-----------------|--------------------------|
| ITEM | DESCRIPTION | REQ'D | MATERIAL | A.S.T.M. |
| 1 | OPERATING NUT | 1 | BRONZE | B-584 ALLOY C83600 |
| 2 | WIPER RING | 1 | RUBBER | D-2000 EPDM |
| 3 | HOLD DOWN NUT O-RING | 1 | RUBBER | D-2000 BUNA N |
| 4 | HOLD DOWN NUT | 1 | BRONZE | B-584 ALLOY C83600 |
| 5 | BONNET O-RING | 1 | RUBBER | D-2000 BUNA N |
| 6 | ANTI-FRICTION WASHER | 1 | CELCON | GRADE M90-04 |
| 7 | OIL FILLER PLUG | 1 | BRASS | B-16 ALLOY 360 |
| 8 | BONNET | 1 | CAST IRON | A-126 CLASS B |
| 9 | HEX BOLT | 8 | STEEL | A-307 ELECTROGALV. GR. B |
| 10 | TOP UPPER BARREL O-RING | 1 | RUBBER | D-2000 BUNA N |
| 11 | UPPER STEM | 1 | CARBON STEEL | A-576 GR 1144T |
| 12 | STEM O-RING | 1 | RUBBER | D-2000 BUNA N |
| 13 | NOZZLE LOCK | 3 | STAINLESS STEEL | A-276 305 OR 410 |
| 14 | PUMPER NOZZLE | 1 | BRONZE | B-584 ALLOY C89833 |
| 15 | PUMPER NOZZLE CAP GASKET | 1 | RUBBER | D-2000 NEOPRENE |
| 16 | PUMPER NOZZLE O-RING | 1 | RUBBER | D-2000 BUNA N |
| 17 | PUMPER NOZZLE CAP | 1 | CAST IRON | A-126 CLASS B |
| 18 | HOSE NOZZLE | 2 | BRONZE | B-584 ALLOY C89833 |
| 19 | HOSE NOZZLE CAP GASKET | 2 | RUBBER | D-2000 NEOPRENE |
| 20 | HOSE NOZZLE O-RING | 2 | RUBBER | D-2000 BUNA N |
| 21 | HOSE NOZZLE CAP | 2 | CAST IRON | A-126 CLASS B |

SEE CAT. RECORD FOR RESPECTIVE PARTS OR SUB. ASS'YS

NOTE: SIZE AND STYLE OF OPERATING NUT, SHOE SIZE, AND THREADING OF NOZZLES IS PER CUSTOMER SPECS.

| ITEM | DESCRIPTION | REQ'D | MATERIAL | A.S.T.M. |
|------|----------------------------|-------|-------------------|--------------------------|
| 22 | CAP CHAIN | 3 | STEEL | ELECTRO GALV. |
| 23 | CHAIN HOOK | 1 | STEEL | ELECTRO GALV. |
| 24 | UPPER BARREL | 1 | CAST IRON | A-126 CLASS B |
| 25 | SAFETY STEM COUPLING | 1 | STAINLESS STEEL | A-890 1.5% SILICON MAX. |
| 26 | SAFETY FLANGE BOLT | 8 | STEEL | A-307 ELECTROGALV. GR. B |
| 27 | BOTTOM UPPER BARREL O-RING | 1 | RUBBER | D-2000 BUNA N |
| 28 | SAFETY FLANGE | 1 | CAST IRON | A-126 CLASS B |
| 29 | COTTER PIN | 2 | STAINLESS STEEL | A-276 302 |
| 30 | CLEVIS PIN | 2 | STAINLESS STEEL | A-276 305 |
| 31 | LOWER STEM | 1 | CARBON STEEL | A-576 GR 1144T |
| 32 | LOWER BARREL | 1 | CAST IRON | A-126 CLASS B |
| 33 | STEM PIN | 1 | STAINLESS STEEL | A-276 302 |
| 34 | DRAIN VALVE FACING | 2 | H.D. POLYETHYLENE | LS 5660-00 |
| 35 | DRAIN VALVE FACING SCREW | 4 | STAINLESS STEEL | A-276 302 |
| 36 | UPPER VALVE PLATE | 1 | BRONZE | B-584 ALLOY C89833 |
| 37 | BOTTOM SEAT O-RING | 1 | RUBBER | D-2000 BUNA N |
| 38 | DRAIN RING | 1 | BRONZE | B-584 ALLOY C89833 |
| 39 | SEAT RING | 1 | BRONZE | B-584 ALLOY C89833 |
| 40 | DRAIN RING HOUSING | 1 | CAST IRON | A-126 CLASS B |
| 41 | MAIN VALVE | 1 | RUBBER | D-2000 NATURAL |
| 42 | LOWER VALVE PLATE | 1 | CAST IRON | A-126 CLASS B |
| 43 | LOCK WASHER | 1 | STAINLESS STEEL | A-276 302 |

| ITEM | DESCRIPTION | REQ'D | MATERIAL | A.S.T.M. |
|------|---------------------------|-------|-----------------|--------------------------|
| 44 | VALVE NUT | 1 | CAST IRON | A-126 CLASS B |
| 45 | VALVE NUT SEAL | 1 | RUBBER | NITRILE |
| 46 | HEX NUT | 8 | STEEL | ELECTRO. GALV. |
| 47 | STEM O-RING | 2 | RUBBER | D-2000 BUNA N |
| 48 | SAFETY FLANGE NUT | 8 | STEEL | ELECTRO. GALV. |
| 49 | DRAIN RING HOUSING O-RING | 1 | RUBBER | D-2000 BUNA N |
| 50 | SLEEVE | 1 | COPPER | B-75 ALLOY 122 |
| 51 | UPPER STEM PIN | 1 | STAINLESS STEEL | A-276 302 |
| 52 | HEX BOLT | 6 | STEEL | A-307 ELECTROGALV. GR. B |
| 53 | SHOE | 1 | DUCTILE IRON | A536 65-45-12 |
| * 54 | PIPE GLAND | 1 | CAST IRON | A-126 CLASS B |
| 55 | TOP SEAT O-RING | 1 | RUBBER | D-2000 BUNA N |
| 56 | HEX NUT | 6 | STEEL | A-307 ELECTROGALV. GR. B |
| * 57 | MECH. JOINT GASKET | 1 | RUBBER | D-2000 NATURAL |
| * 58 | T-HEAD BOLT | 6 | STEEL | A-242 TYPE 1 |
| * 59 | HEX NUT | 6 | STEEL | A-242 TYPE 1 |
| 60 | COVER | 1 | DUCTILE IRON | A536 65-45-12 |
| 61 | ENCAPSULATED FLAPPER | 1 | EPDM | |
| 62 | HEX BOLT | 6 | STEEL | A-307 ELECTROGALV. GR. B |
| * 63 | HEX NUT | 6 | STEEL | A-242 |
| 64 | COVER O-RING SEAL | 1 | RUBBER | -373 BUNA N |
| 65 | BRASS SEAT | 1 | BRONZE | B-584 ALLOY C89833 |
| 66 | SET SCREW | 3 | STAINLESS STEEL | A-276 302 |
| 67 | FLAPPER INSERT | 1 | DUCTILE IRON | A536 65-45-12 |
| 68 | REINFORCED FABRIC | 1 | FABRIC | |

* NOT SHOWN

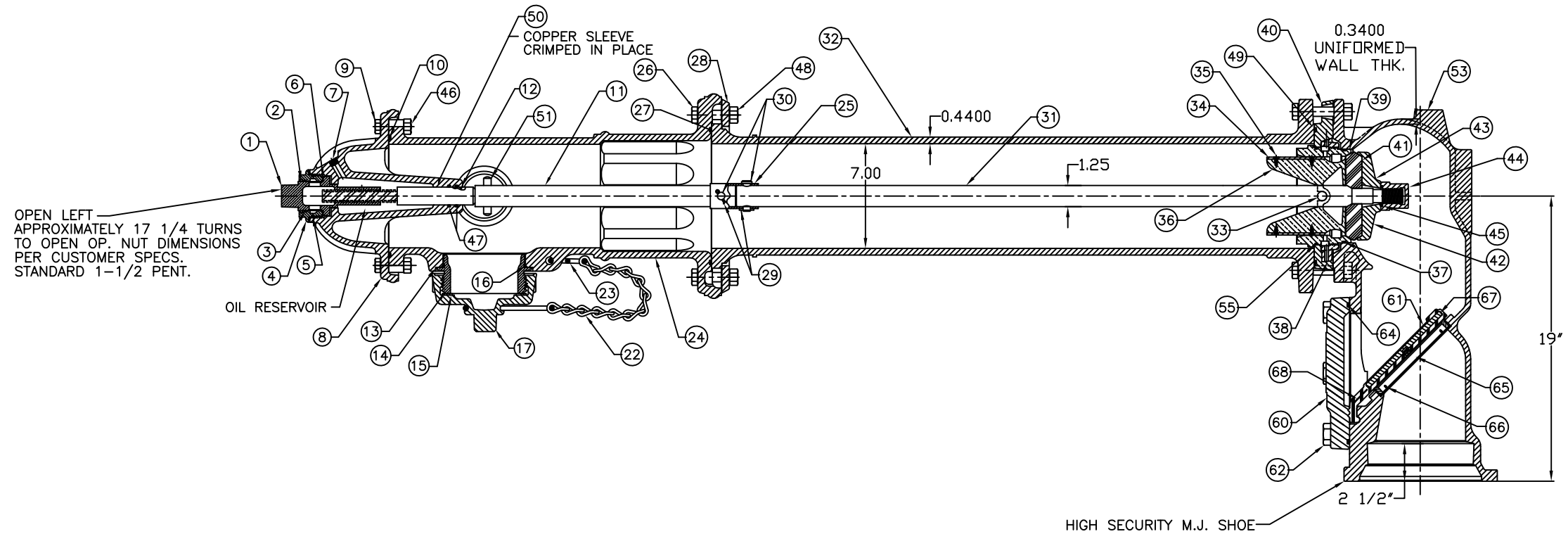

OPEN LEFT APPROXIMATELY 17 1/4 TURNS TO OPEN OP. NUT DIMENSIONS PER CUSTOMER SPECS. STANDARD 1-1/2 PENT.

HIGH SECURITY M.J. SHOE

| APPROX. (MILLIMETER) | | TOLERANCES - MACHINING | | THIRD ANGLE PROJECTION | |
|----------------------|-------------|--|-------------------------------------|------------------------|--------|
| INCH | | UNLESS OTHERWISE NOTED | | PUNCH FINISH | |
| DRWTR | ANC 8-25-07 | BREAK EDGES | FINISH SURFACES | REF. NO. | SCALE |
| CHKR | CJD 8-25-07 | MACH. .006/.016 | 125° | STK. NO. | N.T.S. |
| APP | | FRACTIONS ±1/64 | DECIMALS 2 PL. ±.025 3 PL. ±.010 | ANGLES ±1° | |
| E.O. NUMBER | | MATERIAL SEE TABLE | | REVISION | |
| | | MATERIAL SEE TABLE | | NUMBER | |
| | | DESCR. 4 1/2" A421 & 5 1/4" A423 SUPER CENTURION "250" W/ TWO HOSE NOZZLES & ONE PUMPER NOZZLE W/ HIGH SECURITY SHOE | | FH 168 | |
| | | | | SHEET 1 OF 1 | |