

AWWA C900 PVC PIPE							
NOMINAL PIPE SIZE	BASE CATALOG NUMBER	THREAD TYPE	SIZE OF TAPPING				FASTENER MATERIAL
			.75"	1"	1.5"	2"	
10"	OD2B1110	CC or IP	075	100	-	-	S6
12"	OD2B1320	CC or IP	075	100	-	-	S6

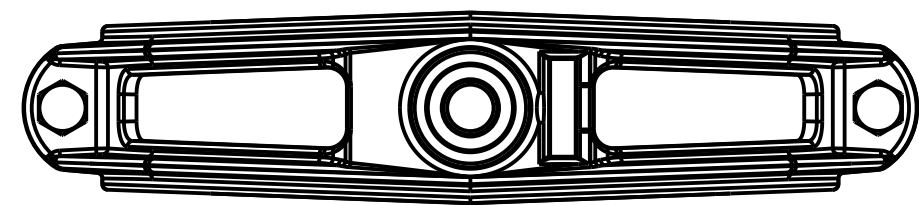

TAPPING SIZE (SEE TABLE)

BOLT MATERIAL 316 SS

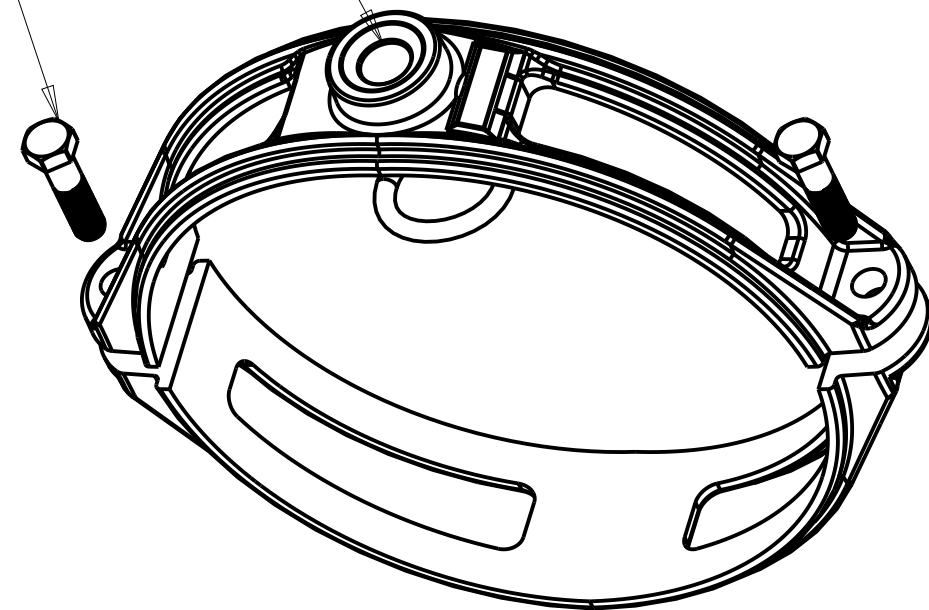

NITRILE O-RING

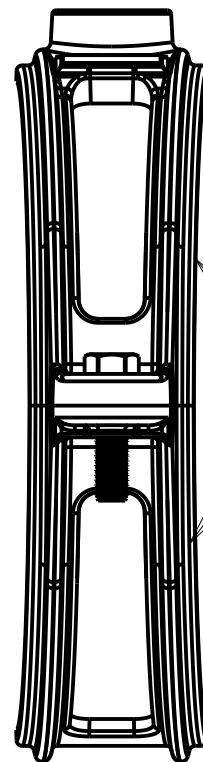
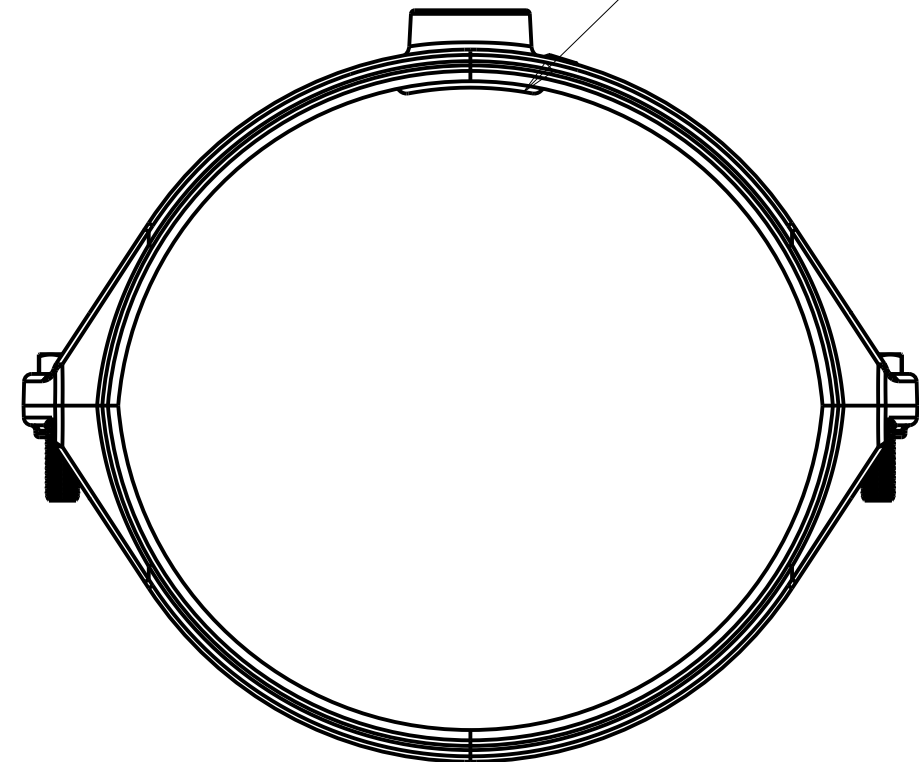

SADDLE AND STRAP MATERIAL  
BRONZE ASTM B62 ALLOY C83600

OD2B-S6

DR. BY	TBE	10/17/17	UNLESS OTHERWISE NOTED		THIRD ANGLE PROJECTION		C.B. NO.
CHKR			BREAK CAST CORNER(S)---				
ENGR			BREAK MACH CORNER(S)---		PURCH. FINISH		PATT. NO.
MGR			TOLERANCES		REF. NO. SCALE		
MFG			UNLESS OTHERWISE NOTED		NONE		
TOOL			LINEAR	ANGULAR	STK. NO.		
FDRY			±	±			
MAT'L: SEE PRINT							
							NUMBER
			DESCR. OD SERIES SERVICE SADDLES FOR C900 PVC PIPE SIZES 10" THROUGH 12" WITH 316 SS FASTENERS				OD2B-S6