

18"-24" DR2W STYLE SERVICE SADDLE WITH ALL AVAILABLE TAP OPTIONS

DR2W-L

PIPE SIZE	PIPE RANGE	TYPE	TAP THREAD*	AVAILABLE TAP SIZES				
				3/4"	1"	1-1/4"	1-1/2"	2"
18"	18.00-19.50	DR2W1800	CC OR IP	075	100	125	150	200
20"	20.00-21.60	DR2W2000	CC OR IP	075	100	125	150	200
24"	24.00-25.80	DR2W2400	CC OR IP	075	100	125	150	200

*IP STANDS FOR AWWA I.P. THREAD (F.I.P.T.)
CC STANDS FOR AWWA TAPER THREAD (C.C.)

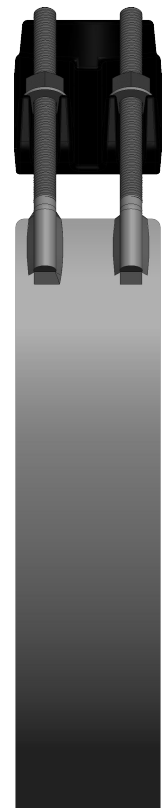

SEE TABLE FOR AVAILABLE TAP SIZES

SADDLE
DUCTILE IRON

HEX NUT
STAINLESS STEEL
W/ TEFLON COATING

WASHER
STAINLESS STEEL

O-RING
NITRILE

STRAP
STAINLESS STEEL

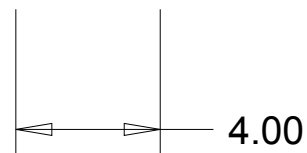

DR. BY	DLG	05/20/15	UNLESS OTHERWISE NOTED		THIRD ANGLE PROJECTION		C.B. NO.
CHKR			BREAK CAST CORNER(S)---				
ENGR			BREAK MACH CORNER(S)---		PURCH.	FINISH	PATT. NO.
MGR			TOLERANCES				
MFG			UNLESS OTHERWISE NOTED				
TOOL			LINEAR	ANGULAR	REF. NO.	SCALE	
FDRY			±	±	STK. NO.		
MAT'L: SEE DRAWING CALLOUTS							
			DESCR.			NUMBER	
			18"-24" DR2W STYLE SERVICE SADDLE WITH ALL AVAILABLE TAP OPTIONS			DR2W-L	