

ITEM NO	PART NUMBER	QTY	DESCRIPTION	MATERIAL
1	507831	1	3/4" CTS 110 COMPRESSION	LEAD FREE BRASS ALLOY ASTM B584 C89833/C87850
2	215B2426551RN	1	5/8" X 3/4" REDUCED PORT BALL VALVE	LEAD FREE BRASS ALLOY ASTM B584 C89833/C87850
3	532099E	1	5/8" & 5/8" X 3/4" METER BAR WITH BRACING EYE	LEAD FREE BRASS ALLOY ASTM B584 C89833/C87850
4	581813E	1	RISER SUB ASSEMBLY W/ SADDLE NUT	COPPER TUBING ASTM B75 UNS 12200 050 TEMPER
5	680005E	1	RISER SUB ASSEMBLY	COPPER TUBING ASTM B75 UNS C12200 050 TEMPER

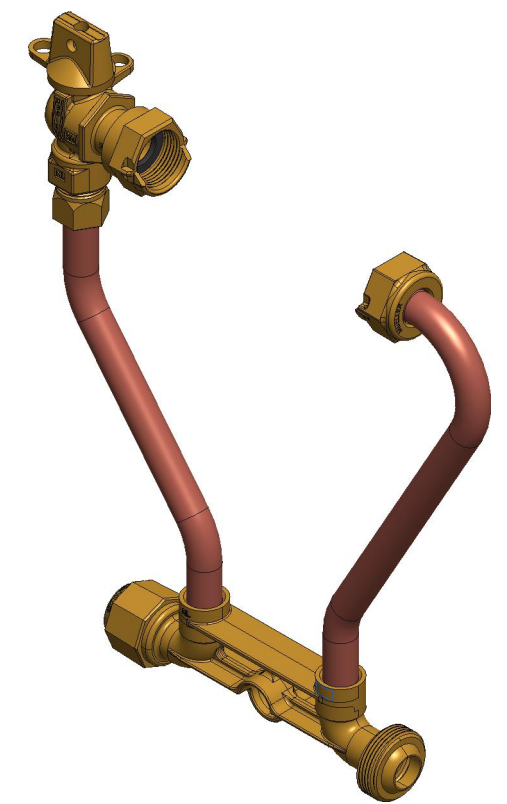
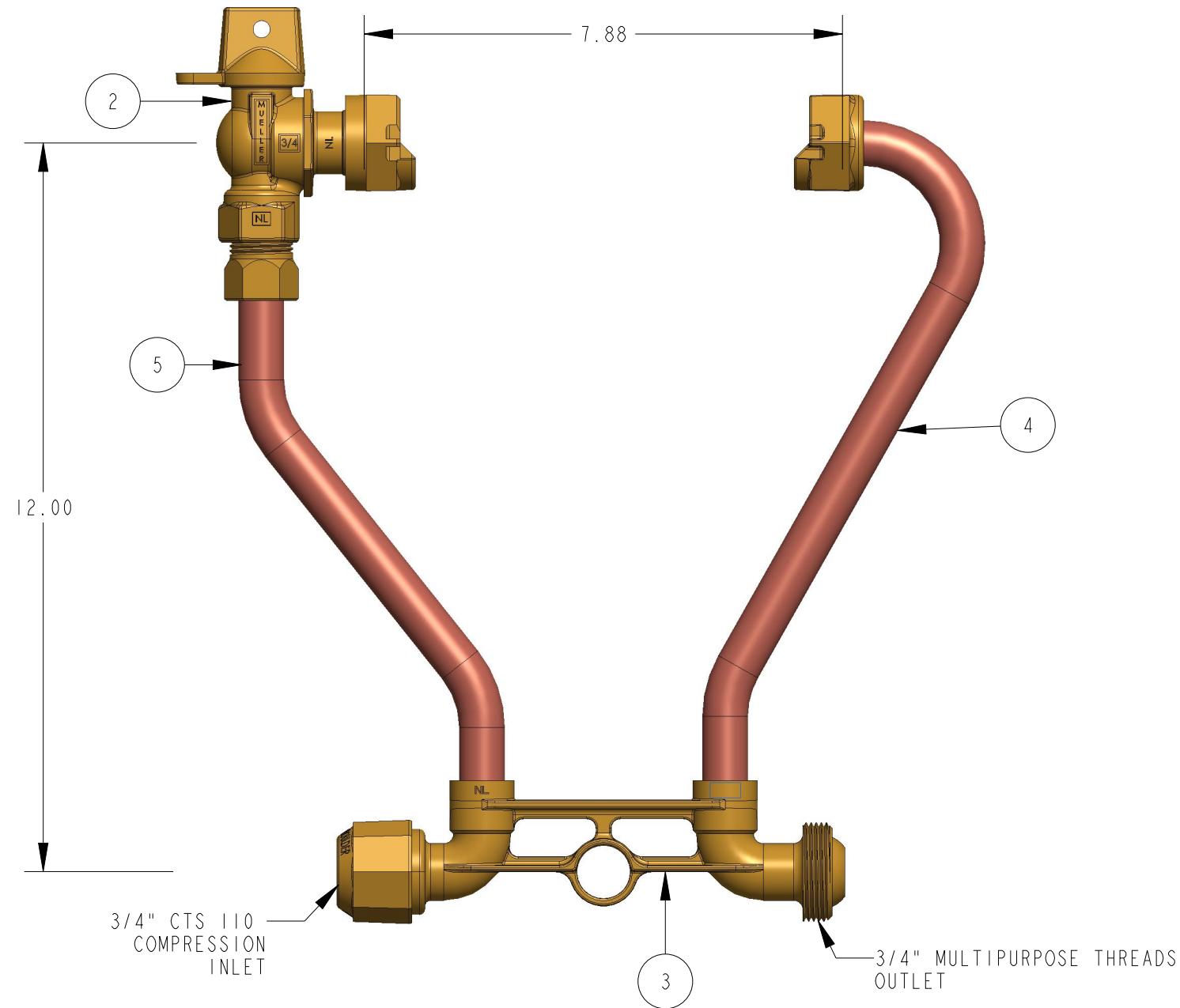

INTERPRET THIS DRAWING IN ACCORDANCE WITH ASME Y14.5 2018		NAME	DATE	THIRD ANGLE PROJECTION	
UNLESS OTHERWISE SPECIFIED DIMENSIONS ARE IN INCHES. MACHINING TOLERANCES:		DRAWN BY	AOS		
.X	±.1	D.E. APPR.		TITLE:	
.XX	±.015	M.E. APPR.		5/8"X3/4" COPPER METER SETTER	
.XXX	±.005	Q.A. APPR.		12" RISER HEIGHT	
ANGULAR	±1°	DO NOT SCALE DRAWING			SIZE
CORNER BREAK	.015/.025	= CRITICAL () = REFERENCE			DWG. NUMBER
FINISH	125 µin. RA	MATERIAL:			REV
		STK NUMBER:			B
		REF.NO.			A
TITLE TO AND OWNERSHIP OF THIS ENGINEERING DATA REMAINS IN Mueller Co. ASSENT ON THE PART OF THE RECIPIENT TO THESE CONDITIONS IS PRESUMED.				SCALE: 0.200	WT:
				SHEET	1 OF 1

REVISIONS					
REV	ECR	DESCRIPTION	DRAWN BY	DATE	APPROVED
A		DRAWING CREATED	AOS	2/13/25	

TITLE TO AND OWNERSHIP OF THIS ENGINEERING DATA REMAINS IN Mueller Co. ASSENT ON THE PART OF THE RECIPIENT TO THESE CONDITIONS IS PRESUMED.