

2-1/16" HOLE DRILLED OUT

* SHIPS SEPERATELY WITH METER PIT
* INSTALL WITH WASHERS

48.00

1" NPT THREADS INLET AND OUTLET

ITEM NO	PART NUMBER	QTY	DESCRIPTION	MATERIAL
1	311955	1	18" DIA SIDE LOCKING COMPOSITE LID (SOLD SEPARATELY)	COMPOSITE MATERIAL
2	548451	1	1" EXTENDED THREADED CONNECTOR	RED BRASS ASTM B43 ALLOY C23000 O61 TEMPER ANNEALED
3	551087	1	18" DIA STEEL PLATFORM	BLUE RILSAN COATED A36 CARBON STEEL
4	700014	1	1" HOSE CONNECTOR	RED BRASS ASTM B43 ALLOY C23000 O61 TEMPER ANNEALED
5	700046-1848	1	1" COIL PART	POLYBUTYLENE RESIN BASELL AKOALIT PB4267 OR 4237 GREY
6	700067	1	NIPPLE 1" X 3"	RED BRASS ASTM B43 ALLOY C23000 O61 TEMPER ANNEALED
7	700581	1	1" X 3-3/4" NIPPLE WITH FLATS	RED BRASS ASTM B43 ALLOY C23000 O61 TEMPER ANNEALED
8	780094-1848	1	SHELL SUB ASSEMBLY	SDR-51 PVC PIPE ASTM D2241 GRADE 1120
9	790010	6	1" HEX NUT	ASTM B16 ALLOY C36000
10	790153	1	18" INSULATION PAD (SOLD SEPARATELY)	ETHAFOAM 220 WHITE OR POLYLAM 1.7 DENSITY WHITE
11	330B20200N	1	1" INLINE BALL VALVE	LEAD FREE BRASS ALLOY ASTM B584 C89833/C87850

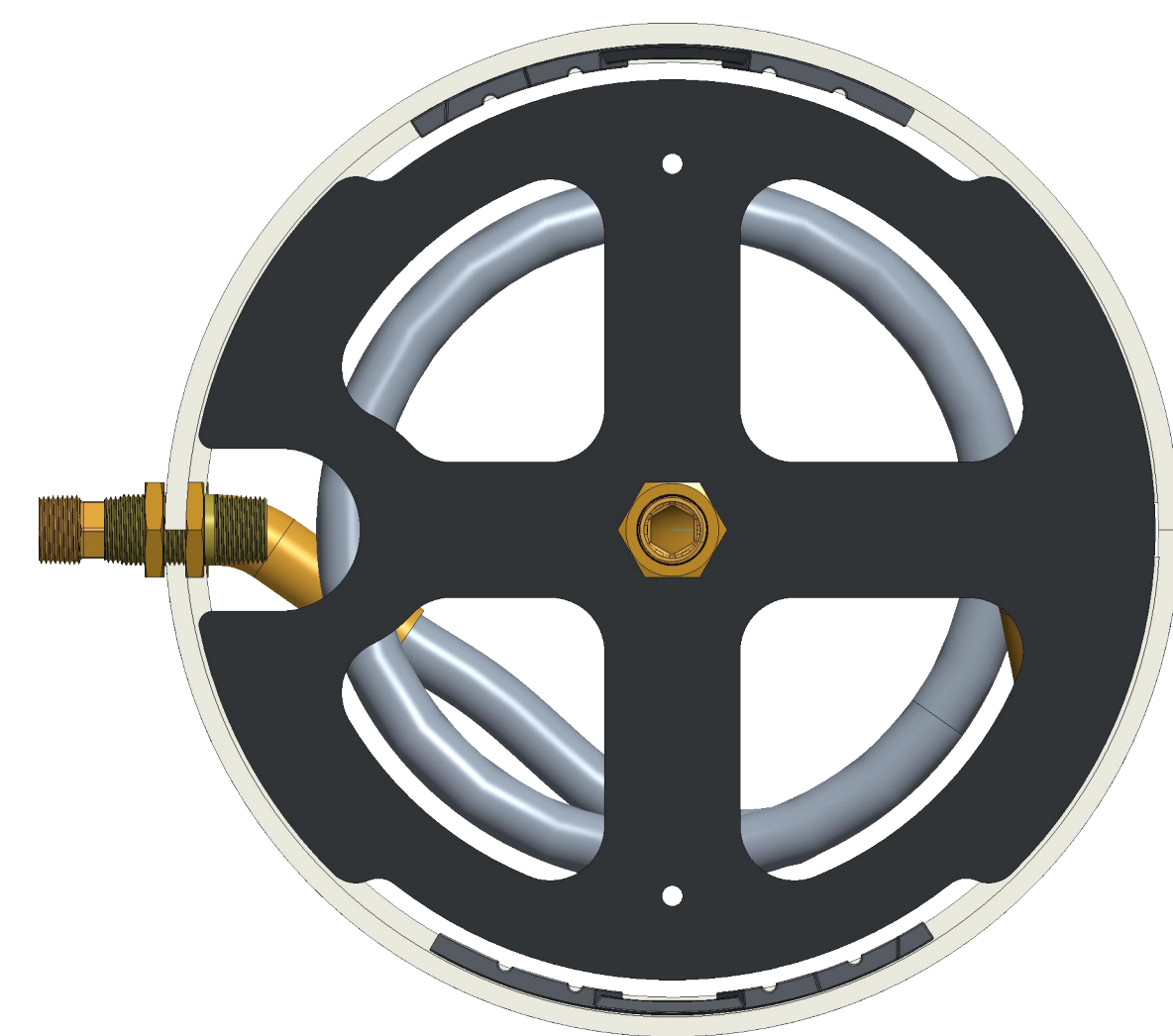

OPTION CODE: 000738
 * BALL VALVE INSTEAD OF ORISEAL
 * 2-1/16" HOLE DRILLED 8" FROM TOP OF SHELL DOWN
 * SPECIAL PLATFORM WITH SLOT
 * SHIP BULKHEAD NIPPLE AND HEX NUTS WITH METER PIT

DR. BY	BBF	9/1/20	UNLESS OTHERWISE NOTED	THIRD ANGLE PROJECTION	C.B. NO.
CHKR			BREAK CAST CORNER(S)---		
ENGR			BREAK MACH CORNER(S)---	PURCH.	FINISH
MGR			TOLERANCES	REF. NO.	SCALE
MFG			UNLESS OTHERWISE NOTED	STR. NO.	
TOOL			LINEAR	ANGULAR	
FDRY			±	±	
MAT'L:			NUMBER		
MUELLER			DESCR. 1" AIR RELEASE METER PIT 18" DIA X 48" DEPTH LOW LEAD BRASS		330AR1848--BS000738N