

METER SIZE	5/8"	5/8"X3/4"	3/4"	1"
A (MINIMUM)	7"	7"	8"	10"
B	7-7/8"	7-7/8"	9-5/16"	11-1/16"
DUAL CHECK VALVE	203HI4244N	215HI4244N	215HI4244N	330HI4244N
ANGLE METER STOP VALVE	203HI4265N	215HI4265N	215HI4265N	330HI4265N
METER BAR	532076E	532076E	050433E	532220E

ITEM NO	PART NUMBER	QTY	DESCRIPTION	MATERIAL
1	HI4244N	1	DUAL CHECK VALVE	LEAD FREE BRASS ALLOY ASTM B584 C89833/C87850
2	HI4265N	1	ANGLE METER STOP VALVE	LEAD FREE BRASS ALLOY ASTM B584 C89833/C87850
3		1	MULTI-PURPOSE METER BAR W/ BRACING EYE	LEAD FREE BRASS ALLOY ASTM B584 C89833/C87850
4		2	RISER SUB ASSEMBLY	COPPER ALLOY C12200

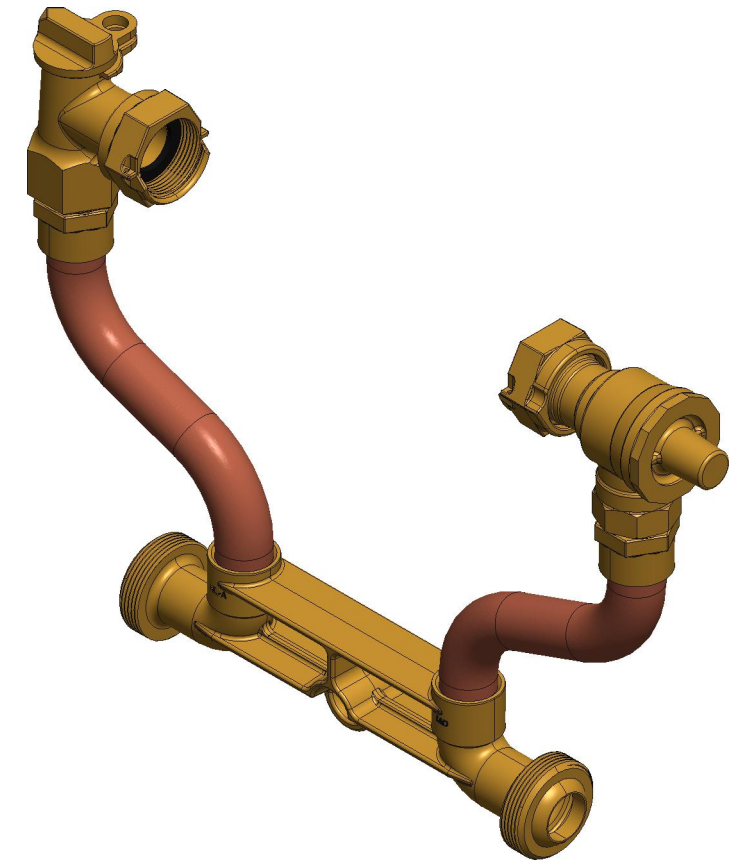
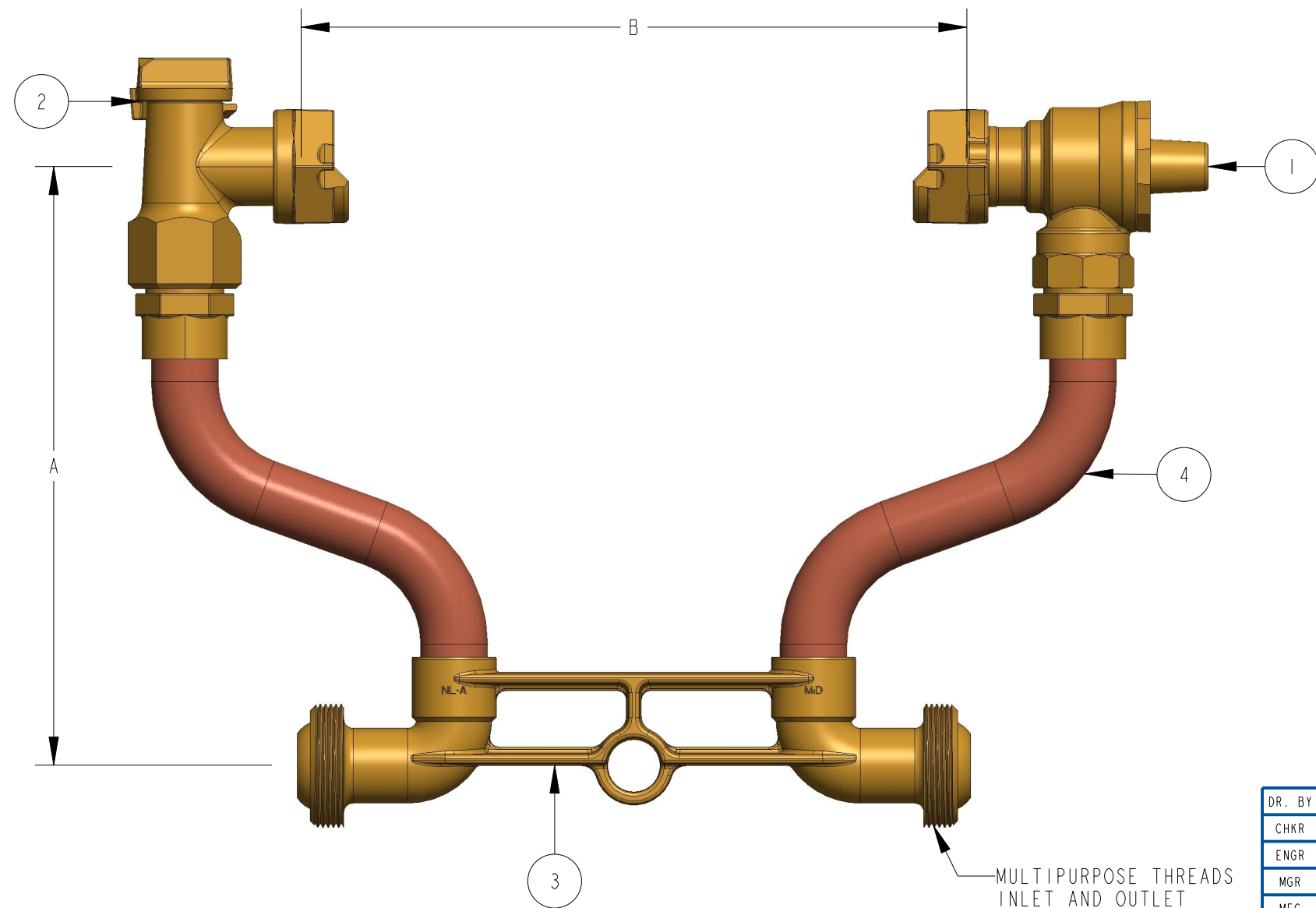

HI404--2---N

DR. BY	AOD	6/23/23	UNLESS OTHERWISE NOTED		THIRD ANGLE PROJECTION		C.B. NO.
CHKR			BREAK CAST CORNER(S)---				
ENGR			BREAK MACH CORNER(S)---		PURCH.	FINISH	PATT. NO.
MGR			TOLERANCES		REF. NO.	SCALE	
MFG			UNLESS OTHERWISE NOTED			NONE	
TOOL			LINEAR	ANGULAR	STK. NO.		
FDRY			±	±			
MAT'L:							
MUELLER			DESCR. COPPER METER SETTER LEAD FREE BRASS			NUMBER HI404--2---N	