



INSTA-TITE® 2.0 CONNECTIONS

Installation Instructions

PREPARE PRODUCT FOR INSTALLATION

1. Wrenches, pliers, etc. **MUST NOT** be used on the grip ring end of the connection. Use wrenches, pliers, etc. only on wrench flats of the valve or fitting.

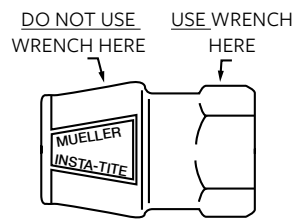
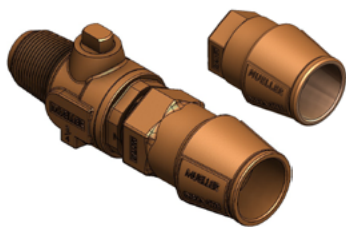

- 2. Keep the interior of the connection clean and free of dirt, sand, etc. If the connection does become soiled, wash thoroughly with clean water.
- 3. Cut pipe square and even (90° perpendicular to run of pipe). Use a rotary cutter or tubing slicer, not a saw, to avoid making pipe burrs.

4. Center the end of the pipe squarely in the end of the Insta-Tite 2.0 connection and push straight in. As a check for proper assembly, we suggest marking the pipe to indicate the amount of pipe that should be stabbed into the Insta-Tite 2.0 connection. The length for each size connection is listed in the chart below. When the pipe is fully inserted, the mark should align with the front edge of the connection body.

5. After pipe is inserted, pull on the pipe to ensure proper grip. Pressure test to ensure no leaks prior to backfill.

6. If the connection is to be buried in sandy or “gritty” soil, tape should be wrapped around the connection and down onto the pipe to cover the gap at the mouth of the connection.

7. If working on live lines, reduce pressure to 80 psi or less to avoid internal component movement.

Size	Type of Pipe	Depth of Insertion
3/4"	IPS HDPE D-2239 or PVC ASTM D-1785 (White grip ring)	2"
1"	IPS HDPE D-2239 or PVC ASTM D-1785 (White grip ring)	2"
3/4"	CTS-HDPE D-2737 or Copper ASTM B88 (Red grip ring)	1-3/4"
1"	CTS-HDPE D-2737 or Copper ASTM B88 (Red grip ring)	1-7/8"

DISASSEMBLY OF CONNECTIONS

1. To remove the pipe from an Insta-Tite 2.0 Connection, slip a pipe removal tool into the connection between the pipe and grip ring and pull the pipe from the connection (use two pipe removal tools on 1" size connections). If experiencing difficulties with removing the pipe, cut the pipe into a short section. This allows for easier rotation out of the fitting using the removal tools while the fitting is held stationary.

2. To reuse the Insta-Tite 2.0 Connection after the pipe has been removed, a new grip ring, plastic guide ring, and lubricated gasket must be used.

Gasket Kit	Part Number
3/4" CTS	683320
3/4" IPS	683321
1" CTS	683322
1" IPS	683323

For more information about Mueller, or to view our full line of water products, please visit www.muellercompany.com.

For customer support, or to report any product issues, please call 1.800.423.1323.

Mueller refers to one or more of Mueller Water Products, Inc. a Delaware corporation ("MWP"), and its subsidiaries. MWP and each of its subsidiaries are legally separate and independent entities when providing products and services. MWP does not provide products or services to third parties. MWP and each of its subsidiaries are liable only for their own acts and omissions and not those of each other. MWP brands include Mueller®, Echologics®, Hydro Gate®, Hydro-Guard®, HYMAX®, iZO®, Jones®, Krausz®, Mi.Net®, Milliken®, Pratt®, Pratt Industrial®, Singer®, and U.S. Pipe Valve & Hydrant. Please see muellerwp.com/brands and krauszusa.com to learn more.

© 2022 Mueller Co., LLC. All Rights Reserved. The trademarks, logos and service marks displayed in this document are the property of Mueller Co., LLC., its affiliates or other third parties. Products above marked with a section symbol (§) are subject to patents or patent applications. For details, visit www.mwppat.com. These products are intended for use in potable water applications. Please contact your Mueller Sales or Customer Service Representative concerning any other application(s).