

Super Centurion® 250 Monitor Hydrant

Mueller Co.



PRODUCT FEATURES

- Model A-479, 4-Way Hydrant – 250psig/17barg maximum working pressure, 500psig/34barg test pressure.
- Integral 4"/DN100 Monitor elbow.
- UL Listed and FM Approved (CE marked to EN 14384 available).
- Meets or exceeds all applicable requirements of ANSI/AWWA C502 Standard and ANSI/NSF 61/372.
- O-ring sealed Bonnet, Ground, and Shoe Flange – better leak resistance, easier maintenance.
- O-ring sealed Oil Reservoir with Filler Plug – permits easy check of oil level and refill without removing Bonnet; filled at factory.
- Automatic operating mechanism lubrication – positive lubrication of stem threads and bearing surfaces each time hydrant is operated.
- Full flow performance – large radius hose and pumper openings and conical Upper Valve Plate reduce turbulence and provide low friction loss.
- Field replaceable, O-ring sealed Hose and Pumper Nozzles – threaded in place and retained by stainless steel locks – NST or BSP threads. Integral Storz connector (as shown) also available to order
- O-ring sealed Bronze Seat Ring – Resists corrosion and easily removed for maintenance through top of hydrant.
- Traffic Flange and stainless steel Stem Coupling – if hydrant is hit, flange and coupling break free preventing damage to stem and main valve, and uncontrolled water flow – coupling will not break into pieces that could drop down and affect valve operation.
- Double Bronze Drains – each time main valve opens or closes, drain valves force-flush drain openings to keep them open for effective barrel drainage.
- Inlet Connections: 6"/DN150 Flanged ANSI B16.1 Class 125 Flat Face (optional PN10, PN16 drilling).

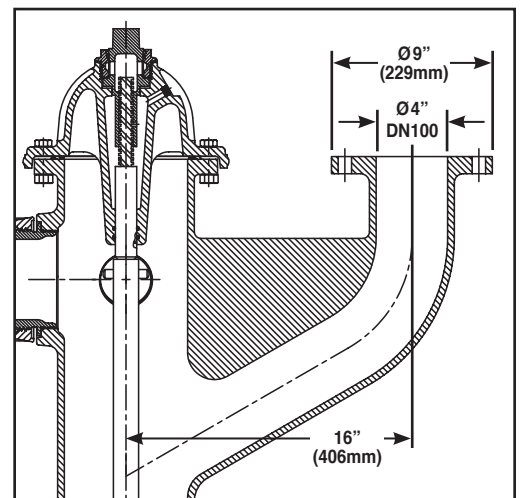
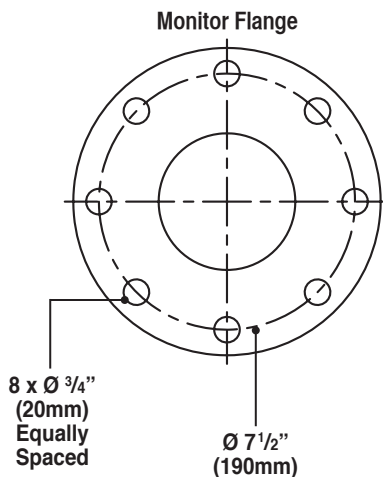
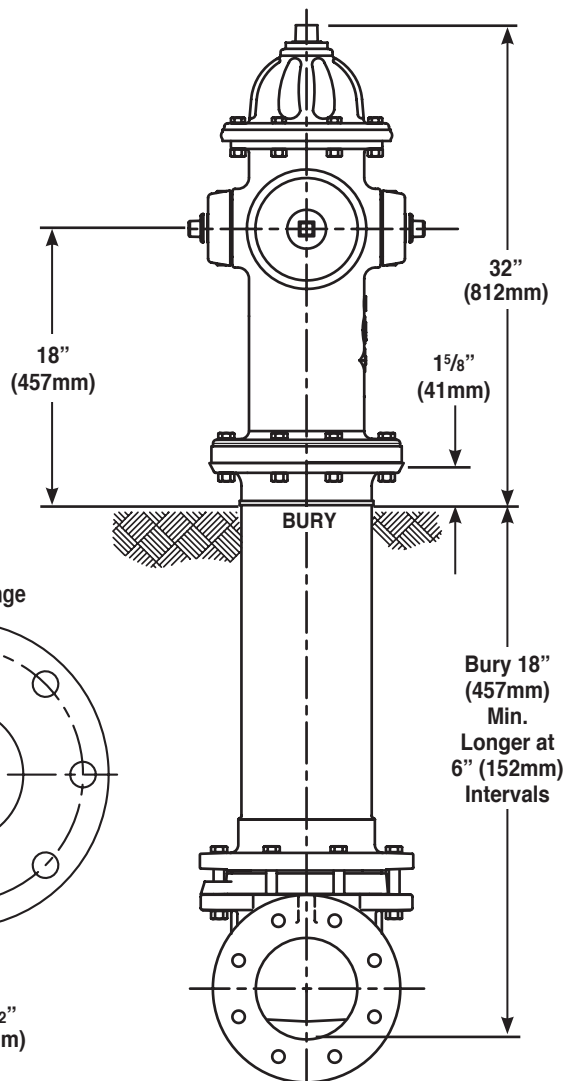

Super Centurion® 250 Monitor Hydrant



PARTS LIST

ID	PART NAME	MATERIAL
1	Operating Nut	Bronze ASTM B62
2	Weather Seal	Rubber ASTM D2000 EPDM
3	Hold Down Nut O-Ring	Rubber ASTM D2000 BUNA N
4	Hold Down Nut	Bronze ASTM B62
5	Bonnet O-Ring	Rubber ASTM D2000 BUNA N
6	Anti-Friction Washer	Acetal
7	Oil Filler Plug	Brass ASTM B16
8	Bonnet	Cast Iron ASTM A126 CL.B
9	Bonnet Bolt	Steel J429 GR. 2
10	Upper Barrel O-Ring	Rubber ASTM D2000 Buna N
11	Upper Stem	Steel ASTM A576 GR.1144T
12	Stem O-Ring	Rubber ASTM D2000 BUNA N
13	Nozzle Lock	Stainless Steel ASTM A276
14	Pumper/Hose Nozzle	Bronze ASTM B584
15	Pumper/Hose Noz. Cap Gasket	Rubber ASTM D2000 Neoprene
16	Pumper/Hose Nozzle O-Ring	Rubber ASTM D2000 BUNA N
17	Pumper/Hose Nozzle Cap	Cast Iron ASTM A126 CL.B
18	Chains, Hooks (not shown)	Plated Steel
22	Upper Barrel	Ductile Iron ASTM A536
23	Stem Coupling	Stainless Steel ASTM A890
24	Traffic Flange Bolt	Steel SAE J429 GR. 2
25	Traffic Flange O-Ring	Rubber ASTM D2000 BUNA N
26	Traffic Flange	Cast Iron ASTM A126 CL.B
27	Cotter Pin	Stainless Steel ASTM A276
28	Clevis Pin	Stainless Steel ASTM A276
29	Lower Stem	Steel ASTM A576 GR.1144
30	Lower Barrel	Cast Iron ASTM A126 CL.B
31	Stem Pin	Stainless Steel ASTM A582
32	Drain Valve Facing	Plastic
33	Drain Valve Facing Screw	Stainless Steel
34	Upper Valve Plate	Bronze ASTM B584
35	Bottom Seat O-Ring	Rubber ASTM D2000 BUNA N
36	Drain Ring	Bronze ASTM B62
37	Seat Ring	Bronze ASTM B584
38	Drain Ring Housing	Cast Iron ASTM A126 CL.B
39	Reversible Encapsulated Main Valve	Natural Rubber ASTM D2000
40	Lower Valve Plate	Cast Iron ASTM A126 CL.B
41	Lock Washer	Stainless Steel ASTM A276
42	Lower Valve Plate Nut	Cast Iron ASTM A126 CL.B
43	Cap Nut Seal	Rubber ASTM D2000 BUNA N
44	Hex Nut	Steel SAE J429 GR. 2
45	Stem O-Ring	Rubber ASTM D2000 BUNA N
46	Traffic Flange Nut	Steel ASTM A563 GR. B
47	Drain Ring Housing O-Ring	Rubber ASTM D2000 BUNA N
48	Sleeve	Copper ASTM B75 Alloy 122
49	Stem Pin	Stainless Steel ASTM A582
50	Shoe Bolt & Nut	Steel SAE J429 GR. 2
51	Shoe* – Flanged	Cast Iron ASTM A126 CL.B
52	Top Seat O-Ring	Rubber ASTM D2000 BUNA N

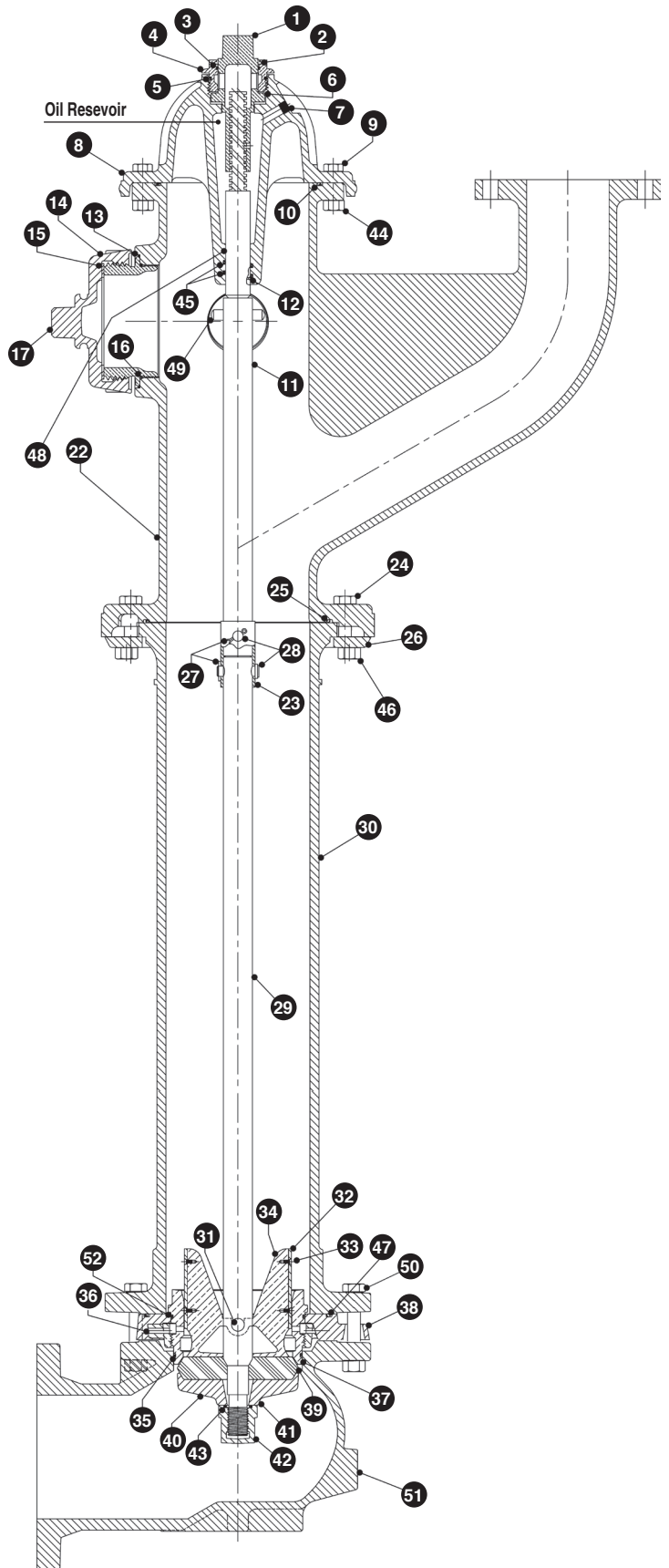

Nozzle Information: 1/Pumper Nozzle (4 1/2"/DN110 NST or BSP),
2/Nose Nozzles (2 1/2"/DN65 NST or BSP)

*6"/DN150 MJ Shoe is Ductile Iron ASTM A536



Copyright © 2017 Mueller Co., LLC. All Rights Reserved. The trademarks, logos and service marks displayed in this document herein are the property of Mueller Co., LLC, its affiliates or other third parties. Products marked with a section symbol (§) are subject to patents or patent applications. For details, visit www.mwppat.com. These products are intended for use in potable water applications. Please contact your Mueller Sales or Customer Service Representative concerning any other application(s).